

NEW BOOSTER STATION IS
OPERATIONAL

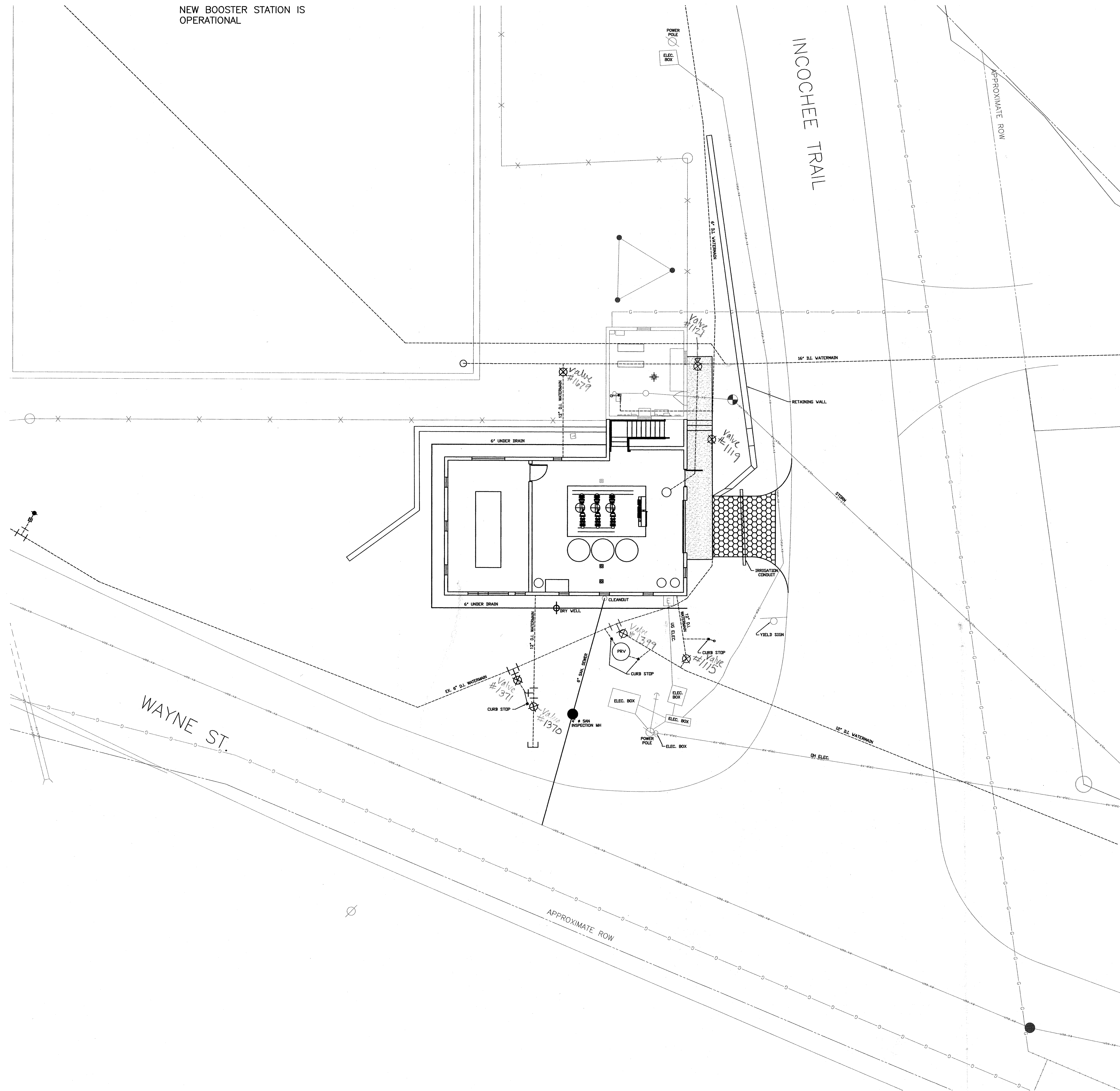

SCALE: 1" = 10'

- ✕ FOUND PROPERTY CORNER
- △ BENCHMARK
- △ SIGN
- △ GAS BOX
- UTILITY POLE
- GUY WIRE
- ⊗ WATER VALVE
- ⊗ PED LIGHT POLE
- ⊗ ELECTRIC RISER
- ⊗ TELEPHONE RISER/BOX
- ⊗ FIRE HYDRANT ASSEMBLY
- CATCHBASIN
- ⊗ BEEHIVE GRATE CATCHBASIN
- ⊗ STORM MANHOLE
- SANITARY MANHOLE
- ⊗ DECIDUOUS TREE
- ⊗ CONIFEROUS TREE
- ☁ TREE LINE
- ✕ EXISTING FENCE
- PROPOSED SANITARY SEWER
- PROPOSED BITUMINOUS PAVED DRIVE
- PROPOSED CONCRETE APRON, SIDEWALK AND STEPS
- ⊗ PROPOSED WATER VALVE
- ⊗ PROPOSED DRYWELL



The City of Traverse City
Engineering Department
GOVERNMENTAL CENTER
400 Boardman Avenue
Traverse City, Michigan 49684

CITY OF TRAVERSE CITY WAYNE HILL BOOSTER PUMP STATION AS-BUILT SHEET

Revision/Issue Date

Date: 09-12-06

Project No: 03-011

Drawn by: JDM

Scale: 1" = 30'

Sheet No: 1 OF 1